

CDimplex[®]



CDFI500-PRO and CDFI500-PRO-RGB

Key Differences



What's New?

The real upgrade → The next generation

Full-Spectrum Flame Colors (RGB LED Strips)

More flame color options: orange, blue, violet, red, and aquamarine (with the new Bluetooth remote), or unlock infinite color variations through the Flame Connect App. *Previous models offered only a single yellow/orange flame using amber LEDs.*

Flame Connect App

Customize every detail of the fire with complete control over flame colors, brightness, crackling sound, and personalized mood presets.

Smart Water-Safety Technology

The advanced water-safety system provides total peace of mind with smart leak detection, dual-valve redundancy, and automatic overflow protection, keeping the cassette running smoothly, cleanly, and worry-free. *Before: 2 solenoid valves and 1 manual valve. Now upgraded to a system with 1 mechanical valve, 1 absorption valve, 1 solenoid valve, and 1 manual valve.*

Upgraded Bluetooth Remote Control

The remote no longer directly pairs 1:1 with cassettes but sends a broadcast signal to all cassettes within Bluetooth range. It sends commands up to 10 cassettes at once.





What's New?

Changes that don't impact performance

4 New Height-Adjustable Legs

Now upgraded from three to four. Note: Not compatible with legacy Pro Boxes (GBF1000-PRO / GBF1500-PRO).

This update supports the redesigned internal structure but does not impact performance.

Compatibility

The CDFI500-PRO-RGB cassette is the core flame engine inside both the Optimyst RGB Pro Box 1000-AM (CBX1000) and Optimyst RGB Pro Box 1500-AM (CBX1500) fireboxes, creating the signature Optimyst flame and smoke effect that brings each unit to life.

Water-Cleaning Filter (Now Standard)

A water-cleaning filter, previously offered as an optional accessory, is now included as standard. This filter helps reduce water hardness, supporting cleaner operation and more consistent system performance.



Visual Comparison

CDFI500-PRO
(Only Yellow LEDs)

CDFI500-PRO-RGB
(Multicolor)

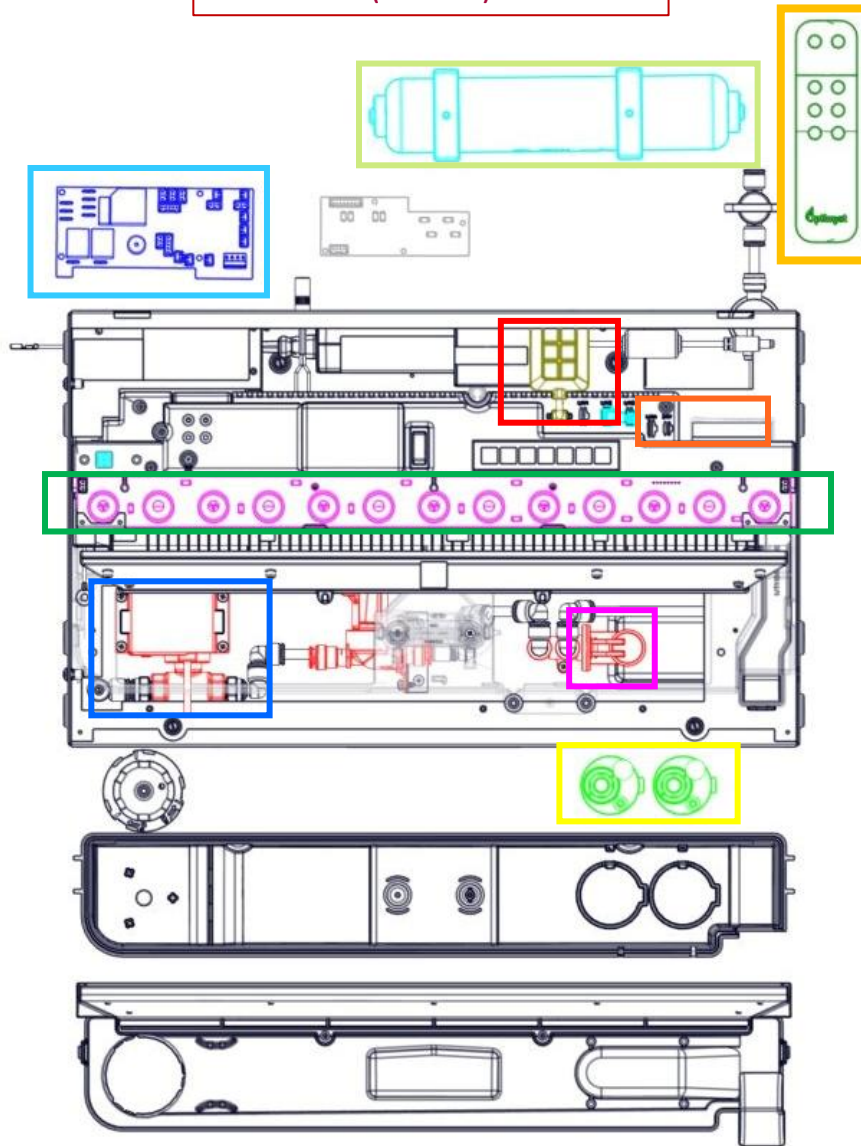
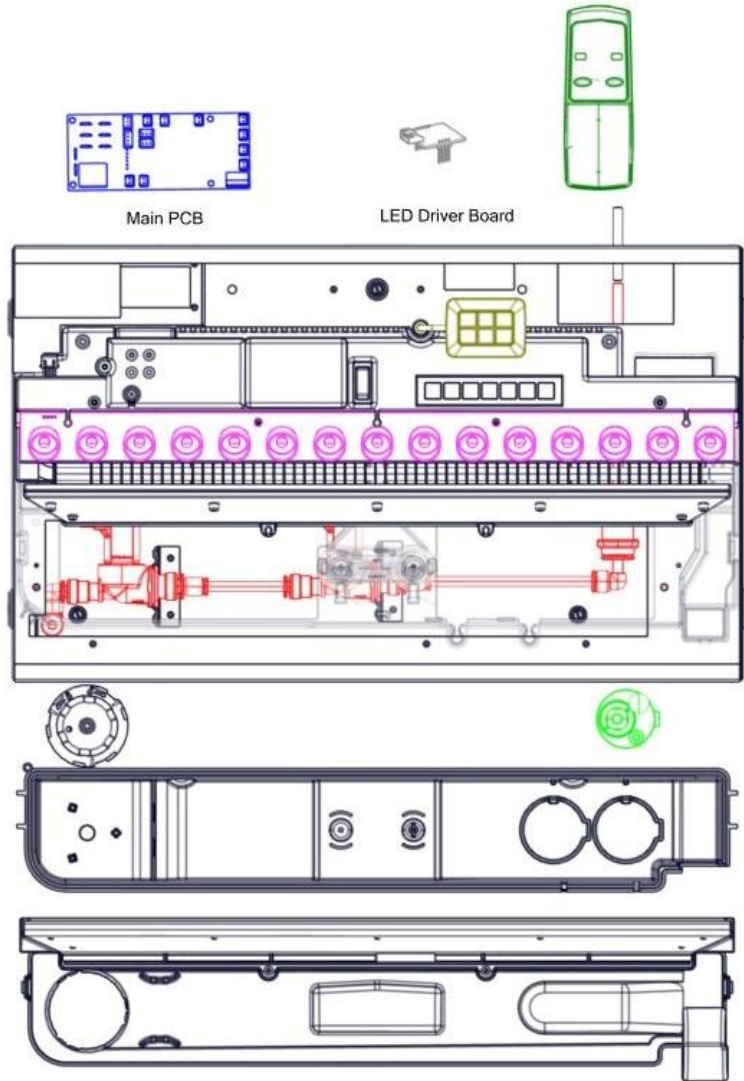

- New UI tether with smart features—linking instructions, Bluetooth for the remote/app, and updated software.
- Updated remote.
- Enhanced LED module with alternating Amber and RGB emitters
- The main PCBA (Control Board) has been updated
- The system has been upgraded from two transducers to three, with one still hidden, allowing for enhanced mist production.
- A water-cleaning filter, previously optional, is now included to help reduce water hardness.
- Absorption valve, added as a safety feature
- Replacement of one solenoid valve with a mechanical valve.
- Linking wire (wire not shown).



What Remains the Same?

Features that still apply

- **Optional Heater Add-On.**
- **Vapor Effect:** Making the flame even more realistic.
- **Antimicrobial Technology:** Inhibits the growth of bacteria by up to 99.99% (tested to ISO 22196 standard.) Regular cleaning and maintenance is required.
- **Refillable Tank or Continuous Water Supply:** Designed to operate either with the 750 ml refillable tank or through a direct connection to a main water line for continuous operation. Accessory plumbing kit is included.
- **Crackling Sounds:** With volume control to enhance the fire experience.
- **Enhanced Flame Effects:** it allows you to adjust the height, and the brightness but also the width, for an even more customizable experience.
- **Modular Design:** Connect multiple cassettes together to achieve the desired length or design for custom installations impossible to accomplish with gas fires.

